

POWERHOUSE MX™ ACHE TIMING SPROCKETS

(Compatible with Poly Chain® GT® Carbon belts)

14 mm Pitch

For 37 mm Wide Belts

Iron

Black Oxide Plating

QD® Style and Taper-Lock® Style

For ACHE (Air-Cooled Heat Exchanger) Applications



Part Number	No. of Teeth	Type	Pitch Dia. (in)	Out. Dia. (in)	Bushing	Face Width (in)	Overall Length (in)	Wt. Ea. (Lbs.)	Material
F28-14MX37-SK	28	A1F	4.912	4.802	SK	1.690	2.000	4	Ductile Iron
F29-14MX37-SK	29	A1F	5.088	4.978	SK	1.690	2.000	5	Ductile Iron
F30-14MX37-SK	30	A1F	5.263	5.153	SK	1.690	2.000	5	Ductile Iron
F31-14MX37-SK	31	A1F	5.439	5.329	SK	1.690	2.000	6	Ductile Iron
F32-14MX37-SK	32	A1F	5.614	5.504	SK	1.690	2.000	7	Ductile Iron
F33-14MX37-SK	33	A1F	5.790	5.680	SK	1.690	2.000	8	Ductile Iron
F34-14MX37-SK	34	A1F	5.965	5.855	SK	1.690	2.000	8	Ductile Iron
F35-14MX37-SK	35	A1F	6.141	6.031	SK	1.690	2.000	9	Ductile Iron
F36-14MX37-SF	36	A1F	6.315	6.206	SF	1.690	2.000	9	Ductile Iron
F180-14MX37-E	180	C3	31.580	31.470	E	2.063	3.000	127	Grey Iron
F180-14MX37-3020	180	C3	31.580	31.470	3020	2.063	3.000	102	Grey Iron
F200-14MX37-E	200	C3	35.089	34.979	E	2.063	3.000	138	Grey Iron
F200-14MX37-3020	200	C3	35.089	34.979	3020	2.063	3.000	115	Grey Iron
F224-14MX37-E	224	C3	39.300	39.190	E	2.063	3.000	155	Grey Iron
F224-14MX37-3020	224	C3	39.300	39.190	3020	2.063	3.000	145	Grey Iron

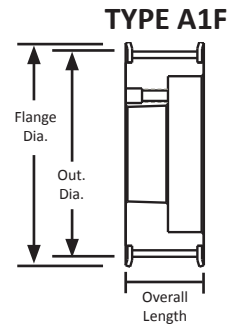

TYPE A1F

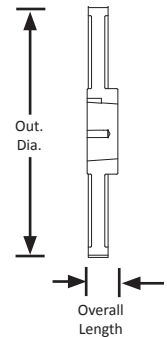

TYPE C3

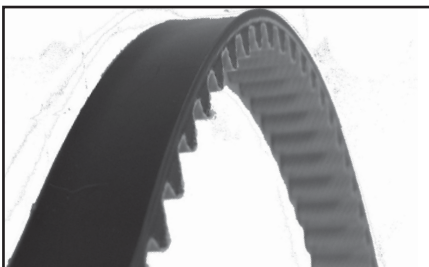

For matching 14 mm Powerhouse MX™ pitch belts, see page 249.



For matching QD® bushings, see page 324.

B&B Manufacturing can tailor your order to your specific needs. We can plate in other materials such as nickel. We can add one or two flanges to your pulley. We can adhere to your special packing instructions. Contact B&B Manufacturing for your specific requirements.